

## RW2030

Pt1000 wire temperature sensor with eyelet



### ► Specific features

- Pt1000 sensor
- Contact measurement by eyelet terminal lug
- 2-wire output + shielding braid
- Measurement range : -50°C to +125°C

### ► Description

Equipped with a Pt1000 sensing element, the RW2030 contact temperature measurement sensor with eyelet can be fixed directly on the lug of a heating element to check its temperature.  
Examples of applications: cooling radiators for the power electronics of the traction systems and batteries.



## ► RW2030 technical specifications

Sensing element	Pt1000 $\Omega$ at 0°C classe A
Galvanic insulation - dielectric tests	1500V-50Hz/60s-threshold 3 mA
Insulation testing	>100 M $\Omega$ sous 500 V
Type of assembly	2-wire output + + ground braid
Measurement range	-50°C to +125°C
Connection	316L stainless-steel eyelet terminal lug, diameter 3.7 mm
Cable	Flexible down to -40°C
ROHS, REACH	Without teflon or halogen as per DIN VDE IEC

## ► Design diagram

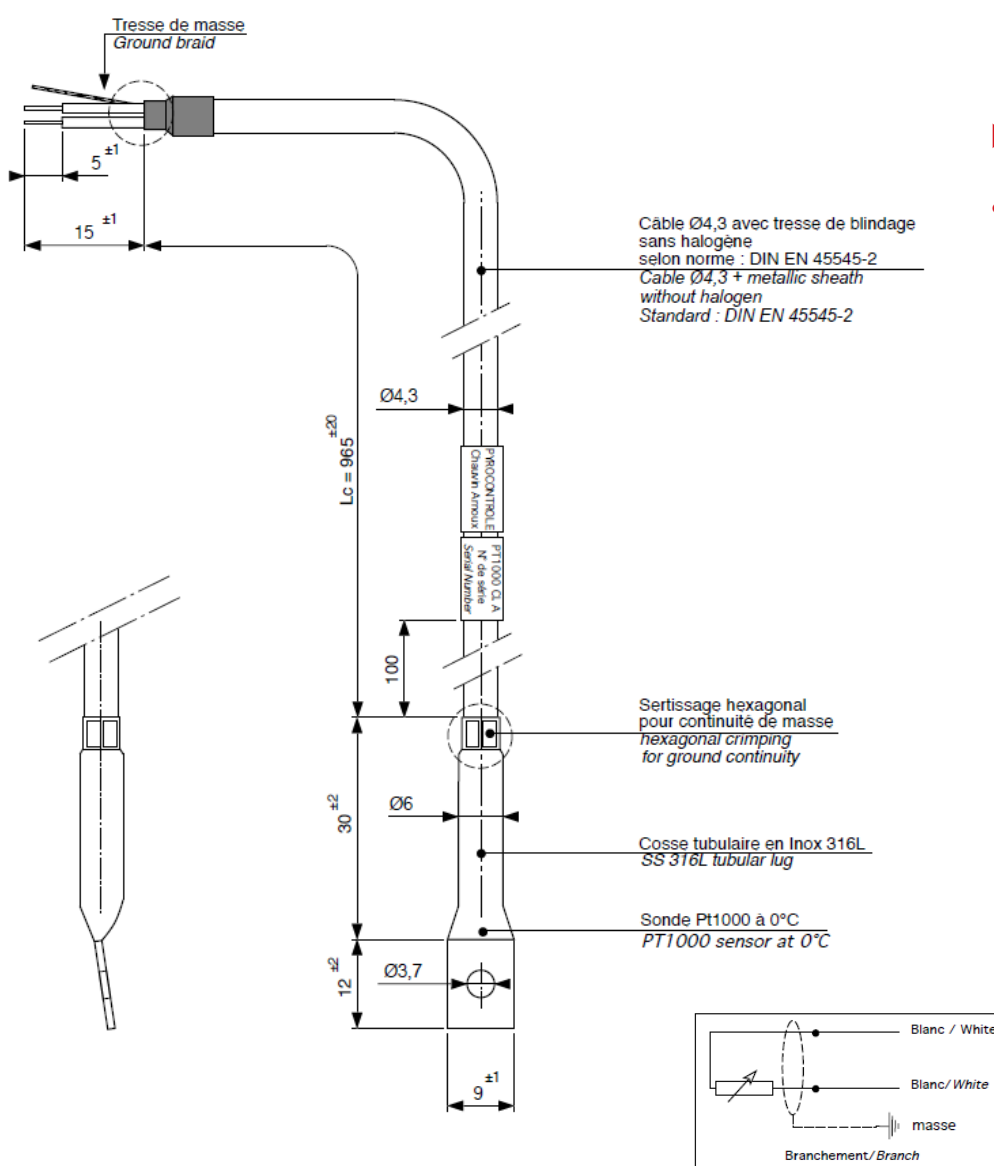

## ► Standard and qualification

- Rail standard:  
EN 45545 (HL1, HL2, HL3)
- Standard Pt1000:  
IEC 60751 Classe A
- Qualification:  
Alstom Transport DTR0000372502

## ► To order

Description	Reference
RW2030 Sensor	L860352-000

## ► Other specifications

For specific products manufactured according to your specifications, please contact us.

**FRANCE**  
**Pyrocontrol**  
 6 bis, av du Docteur Schweitzer  
 69881 MEYZIEU Cedex  
 Tél : +33 4 72 14 15 40  
 Fax : +33 4 72 14 15 41  
 info@pyrocontrol.com  
 www.pyrocontrol.com

**INTERNATIONAL**  
**Pyrocontrol**  
 6 bis, av du Docteur Schweitzer  
 69881 MEYZIEU Cedex  
 Tél : +33 4 72 14 15 45  
 Fax : +33 4 72 14 15 41  
 export@pyrocontrol.com

**SUISSE**  
**Chauvin Arnoux AG**  
 Moosacherstrasse 15  
 8804 AU / ZH  
 Tél : +41 44 727 75 55  
 Fax : +41 44 727 75 56  
 info@chauvin-arnoux.ch  
 www.chauvin-arnoux.ch

**CHAUVIN**  
**ARNOUX**  
 GROUP